

Zeno Up

design
Jan Van Lierde

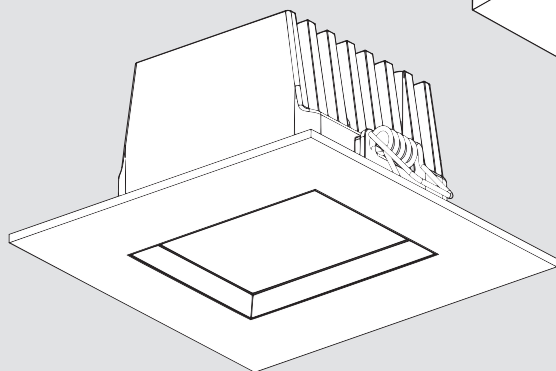

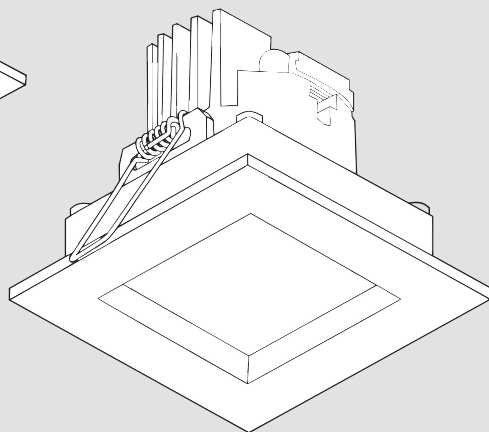
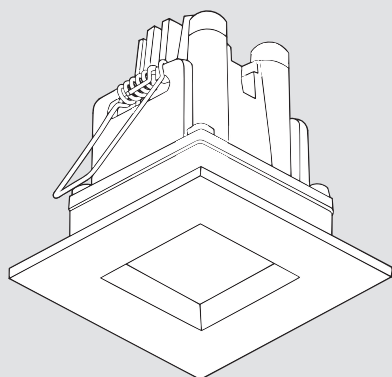
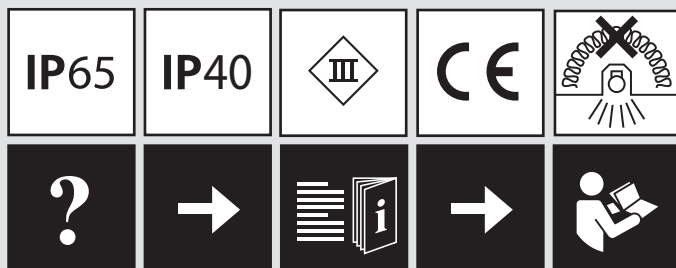

Zeno Up 2

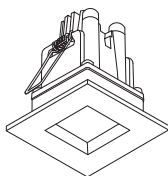
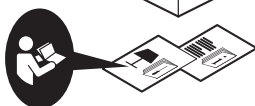
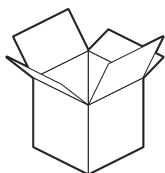

LED 0



Zeno Up 3

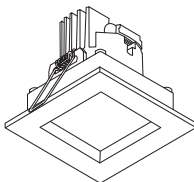
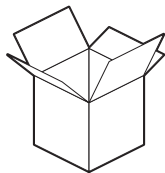

LED 1
from
Dthr 95 cm



Zeno Up 4

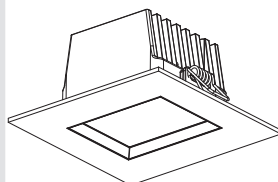
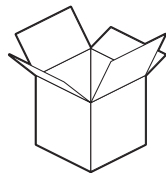

LED 0

i

Zeno Up 2

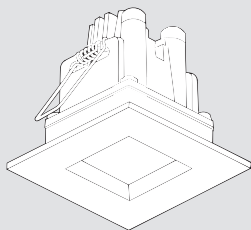

50 x 50 mm

Zeno Up 3

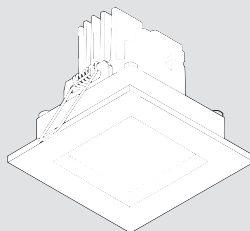

65 x 65 mm

Zeno Up 4

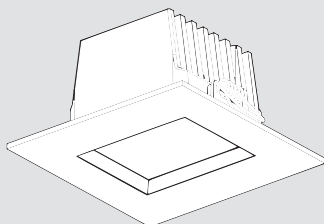

90 x 90 mm

i

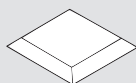

Zeno Up 2: 38 x 36mm

Zeno Up 3: 52 x 56mm

Zeno Up 4: 79 x 79mm

Zeno UP IP40

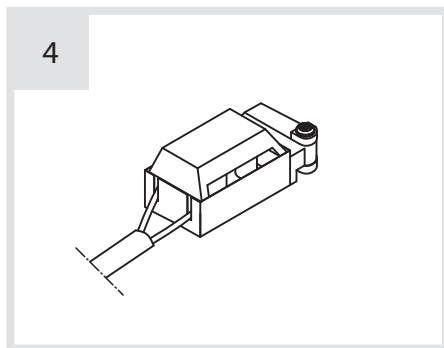
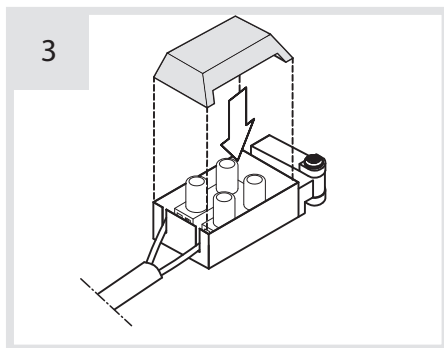
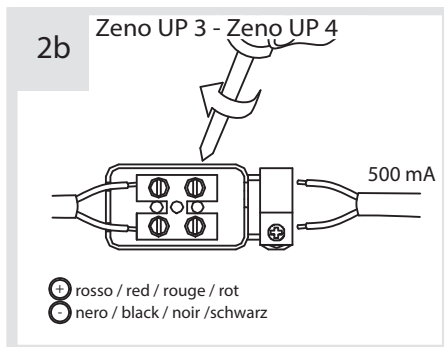
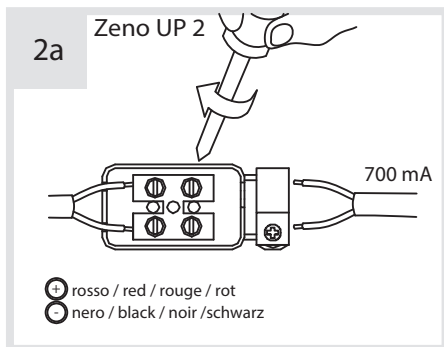
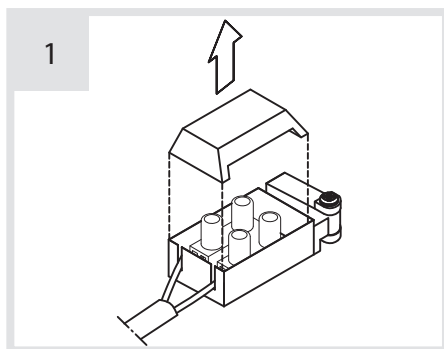
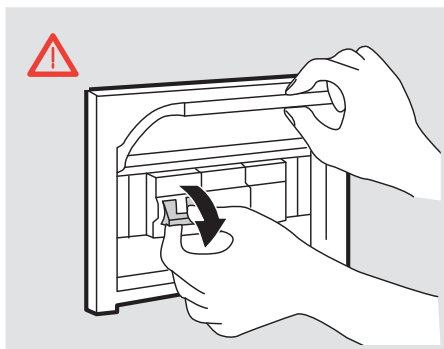

Collegamento in serie - Series connection - Connection en série Hintereinander schaltung - Conexion en serie



Per evitare di danneggiare il led effettuare tutti i collegamenti prima di dare tensione.

To avoid damages to led unit all connection shall be made before to switch power on.

Pour éviter d'endommager le conduit à faire toutes les connexions avant d'appliquer le pouvoir.

Um eine beschädigung der led zu vermeiden, bitte produkte erst nach dem anschluss einschalten.



Zeno UP IP65

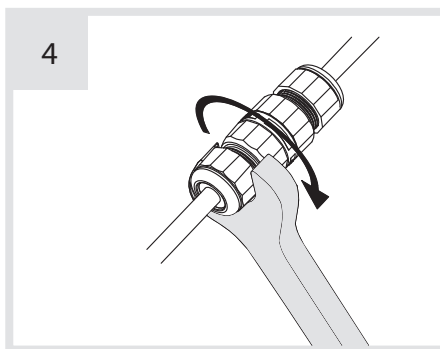
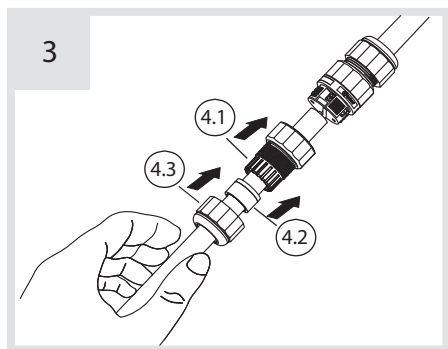
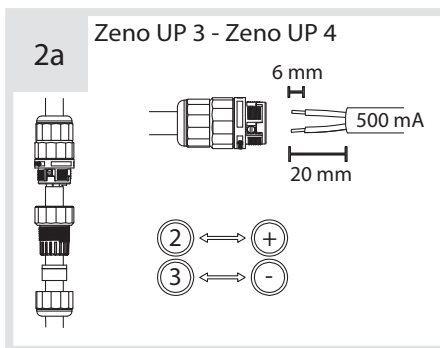
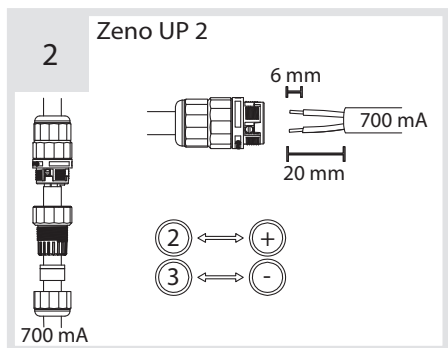
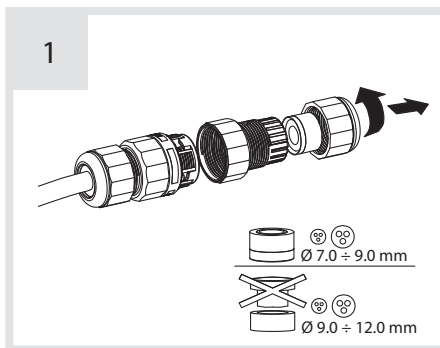
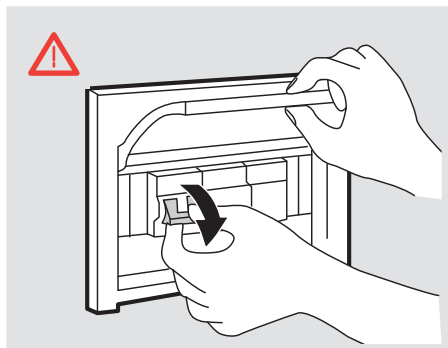

Collegamento in serie - Series connection - Connection en série
Hintereinander schaltung - Conexion en serie



Per evitare di danneggiare il led effettuare tutti i collegamenti prima di dare tensione.
To avoid damages to led unit all connection shall be made before to switch power on.

Pour éviter d'endommager le conduit à faire toutes les connexions avant d'appliquer le pouvoir.
Um eine beschädigung der led zu vermeiden, bitte produkte erst nach dem anschluss einschalten.



5

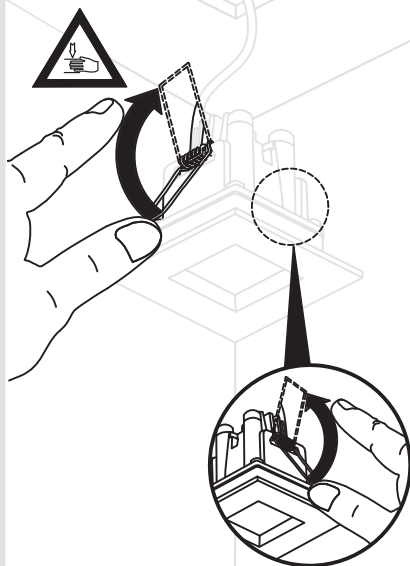

6

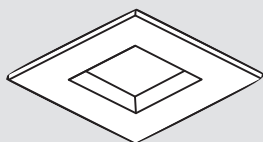
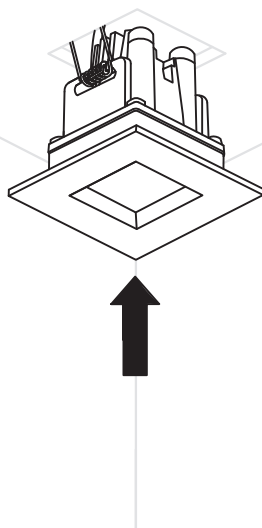



Artemide®



Artemide Spa

via Bergamo, 18
20010 Pregnana M.se (MI)
ITALIA

tel. +39 02 935 181
fax +39 02 935 90 254
fax +39 02 935 90 496

www.artemide.com

VAT IT00846890150

cod. Y513500095D